



The Broadcast Producer's Guide to LinkedIn Live



Events are a powerful way to build community, create brand associations, and share exciting information. In these uncertain times, many organizations have started to look for alternatives to in-person gatherings. Virtual events help keep safety at the forefront, while ensuring business activities can still run effectively.

Our goal is to be as supportive as possible to minimize disruption to your business. That's why we've created a guide with some helpful resources for conducting successful virtual events on LinkedIn to help you along this journey.

If you're just getting started and need more generalized advice on how to get started with LinkedIn Live, please check out our LinkedIn live [resource hub](#) and [best practices site](#) to learn more.

In this guide:

- 1 Overview
- 2 Getting Access
- 3 Broadcast Tools
- 4 Videos Specs
- 5 Captions

Appendix

Step-by-Step Instructions

- [Restream](#)
- [Wirecast](#)
- [Teradek Core](#)
- [Live U Solo](#)
- [Wowza Cloud](#)
- [Easy Live](#)
- [Vimeo Live](#)

Quick Links

- [LinkedIn Live Resource Hub](#)
- [Applying to become a LinkedIn Live Broadcaster](#)

Overview

All of the broadcast tools and workflows mentioned below were co-developed by LinkedIn Media Productions in partnership with the Video Product team at LinkedIn. All of these workflows have been fully stream-tested from our live shows, and most of these workflows are in use currently by the LMP team.

This guide will be useful if any of the circumstances apply to you:

- You are a professional TV, studio and/ or event producer that wants to stream live via LinkedIn
- You are already producing professional, multi-camera productions and need further guidance on how to deliver these streams to the LinkedIn platform

Please share the technical information in this guide with your broadcast production team.



Getting access to LinkedIn Live

At present, LinkedIn Live is not available to all members and Pages on LinkedIn. All interested members and organizations should apply for access at this [link](#). If your organization has a LinkedIn Marketing Solutions account representative, you may go through that person for access as well.

Note: Not all admins have access to stream on behalf of a Page that has been approved for LinkedIn Live. In your application, please indicate at least 1 admin who will be in charge of streaming on behalf of your Page.



Testing

Currently, two of our third-party broadcast tools allow you to conduct test streams: [Switcher Studio](#) and [Wirecast](#). If you're new to streaming and want to test out your technical setup in a "draft mode," these are the tools to use. If neither of them are an option for your organization, we recommend that your first stream is smaller in scale, with less promotion than you might consider for subsequent streams. Embrace the fact that live is unfiltered and authentic, which is what members are looking for from brands with this format!

Broadcast Tools

If you're a professional live production company or news/media outlet, it is likely that you already have an established production/streaming workflow with preferred live video encoders already in use. Since direct Custom RTMP ingest is not supported on the LinkedIn Live platform at present, you will need to send the RTMP ingest from your encoders to a cloud solution for LinkedIn authentication. The following cloud multi-streaming offerings have been vetted by LMP with full integration into LinkedIn Live:

Cloud Solutions: For use with your existing video encoder

- Restream
- Wowza Cloud
- EasyLive
- Vimeo Live

Hardware Encoder Options:

- Live U Solo → Solo Portal
- Teradek Cube → Teradek Core
- Wowza Clearcaster → Wowza Cloud

Software Encoder Options:

- Wirecast

[See our full guide to Broadcasting Tools here](#)



Video Specs (Encoder Settings)

Max Ingest from Encoder (ingress):

Aspect Ratio	16:9
Resolution	Up to 1080p
Frame Rate	Up to 30 fps
Key Frame	every 2 seconds (60 frames)
Bitrate	max 6 mbps video; max 128 kbps audio, 48 KHz sample rate
Encoding	H264 video, AAC audio

LinkedIn Live Player (egress):

Aspect Ratio	16:9
Resolution	max 720p
Frame Rate	max 30 fps
Key Frame	every 2 seconds (60 frames)
Bitrate	3.5 mbps
Encoding	H264 video, AAC audio

Captions

The LinkedIn Live player accepts captions via 608/708 CEA passthrough from the following broadcast tools:

- Restream
- Wowza Cloud
- Vimeo Live

The following appendix includes step-by-step instructions for streaming with a variety of third-party tools. For troubleshooting assistance, [please visit our online resources](#).



Appendix

Step-by-step guides

Restream

Use your own encoder to send a stream to Restream's RTMP endpoint and then connect to LinkedIn Live.

See our step by step guide below or watch this [instructional video](#).

Supports Captions passthrough via 608/708

Step 1 — When setting up Restream for the first time, first remove the branding

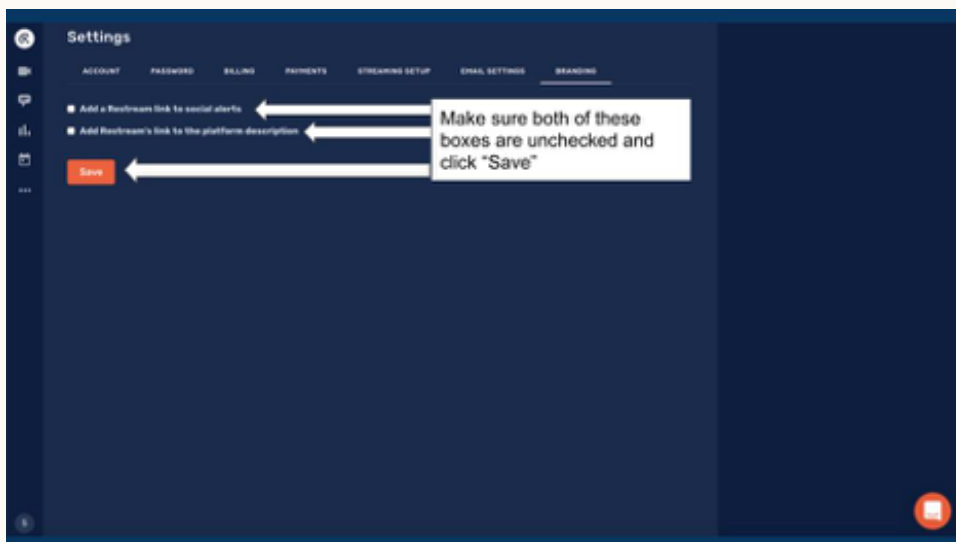
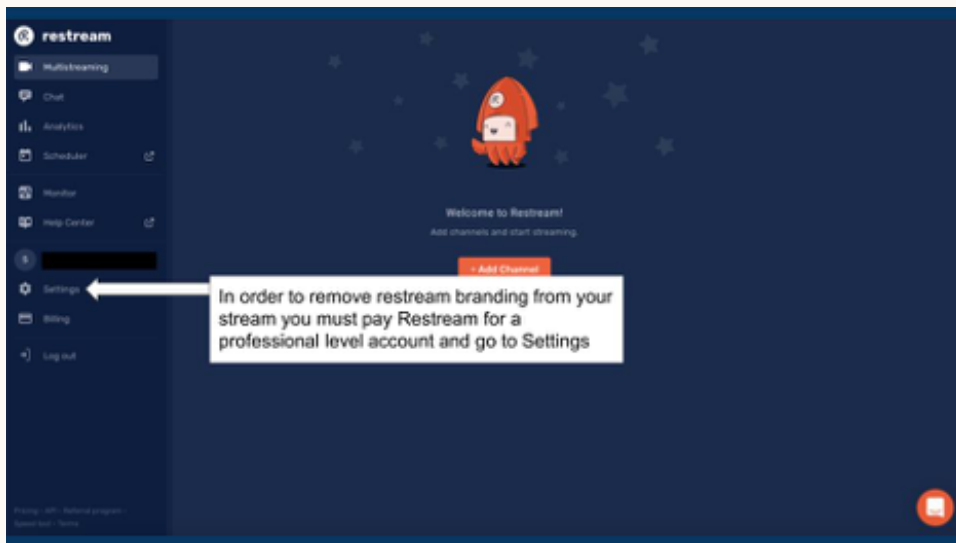

Step 2 — Now set up your channel to connect to LinkedIn Live

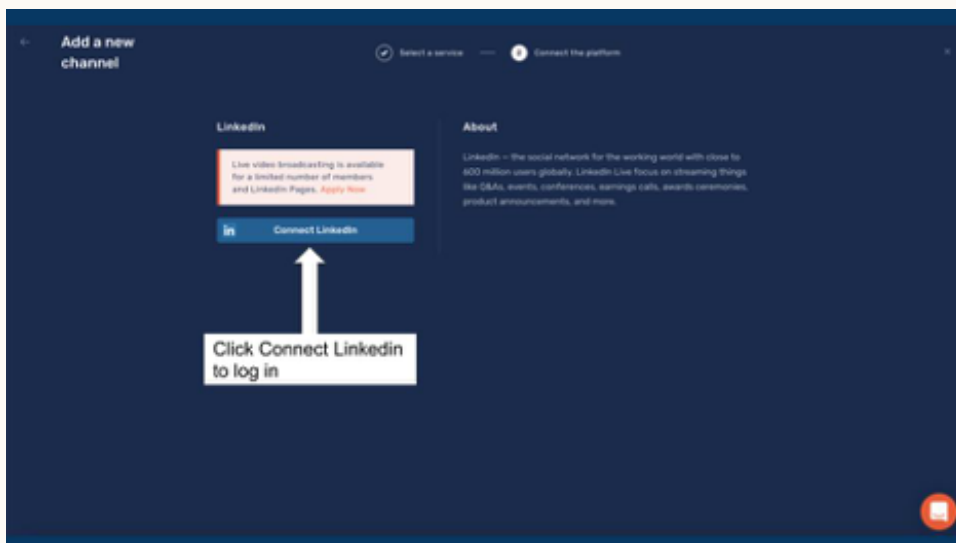
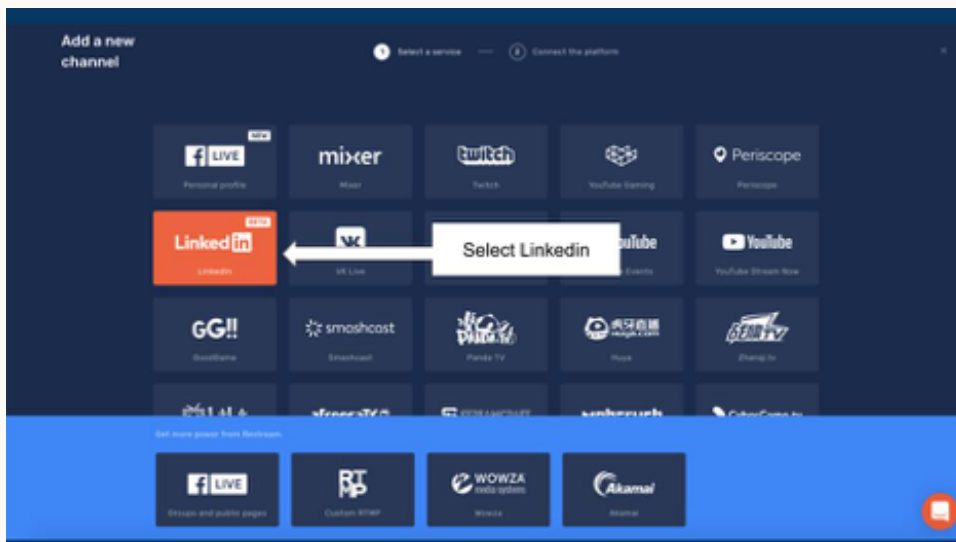
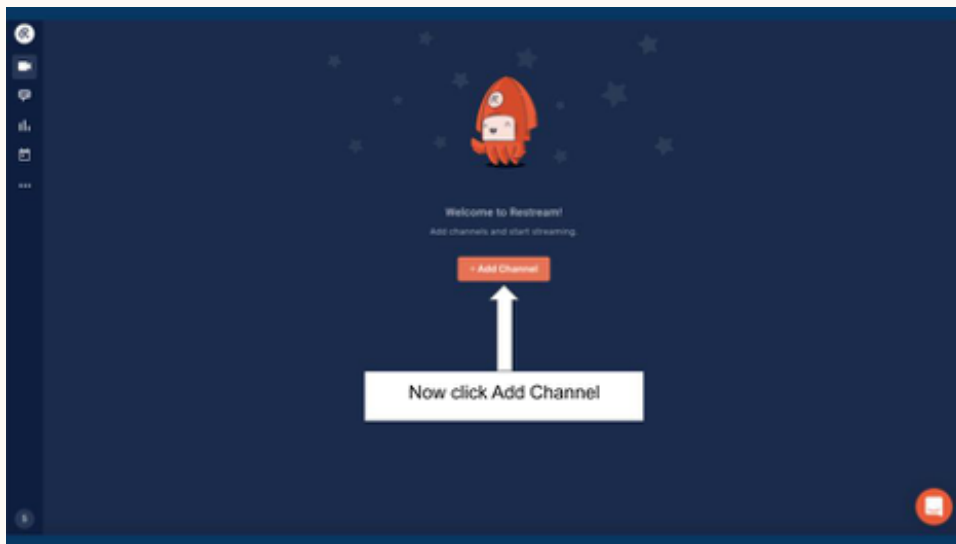

Step 2 — Now set up your channel to connect to LinkedIn Live (continued)

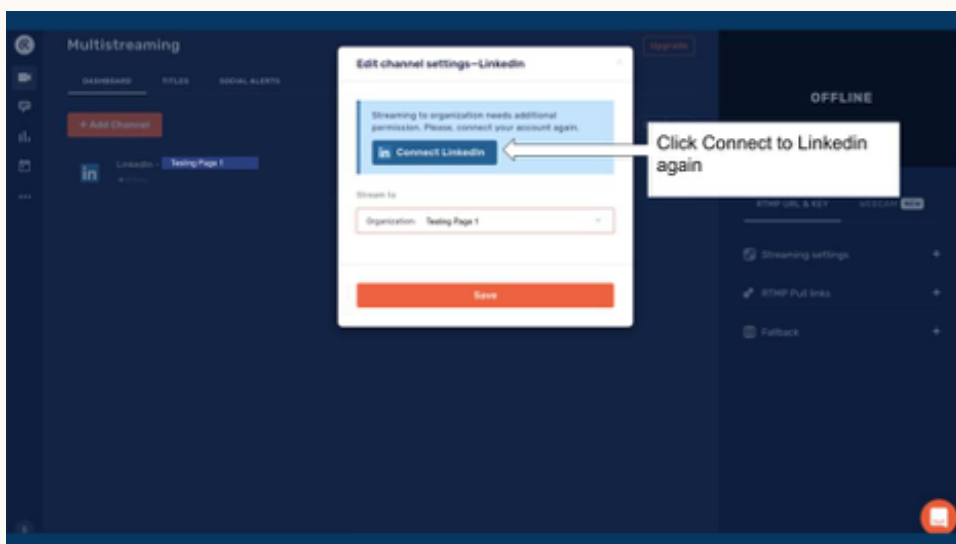
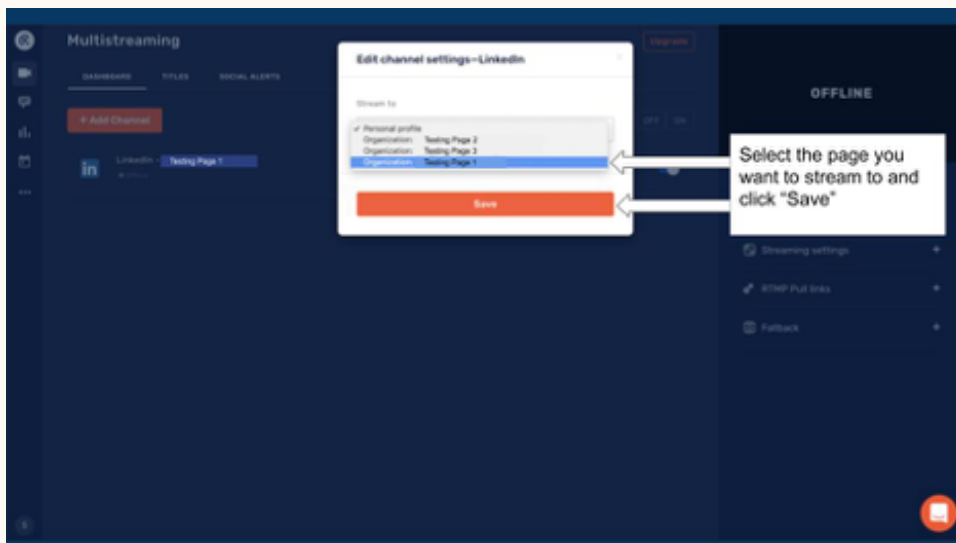

Step 2 — Now set up your channel to connect to LinkedIn Live (continued)



Step 3 — Toggle off slider and change title and post copy information

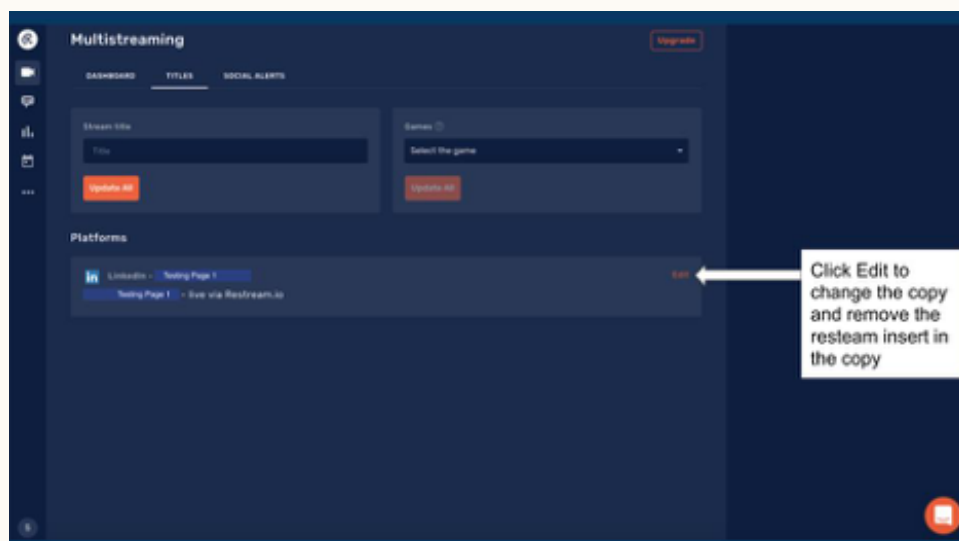
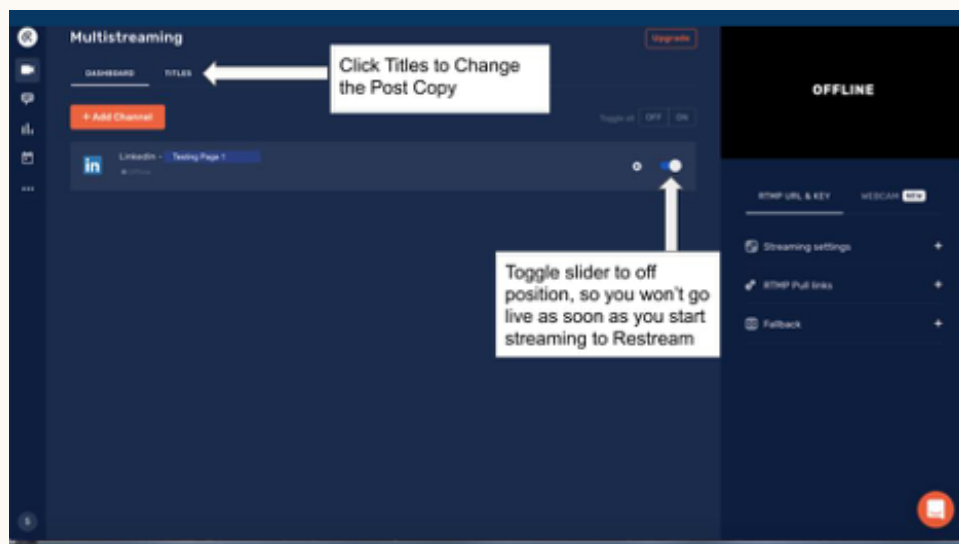

Step 3 — Toggle off slider and change title and post copy information (continued)

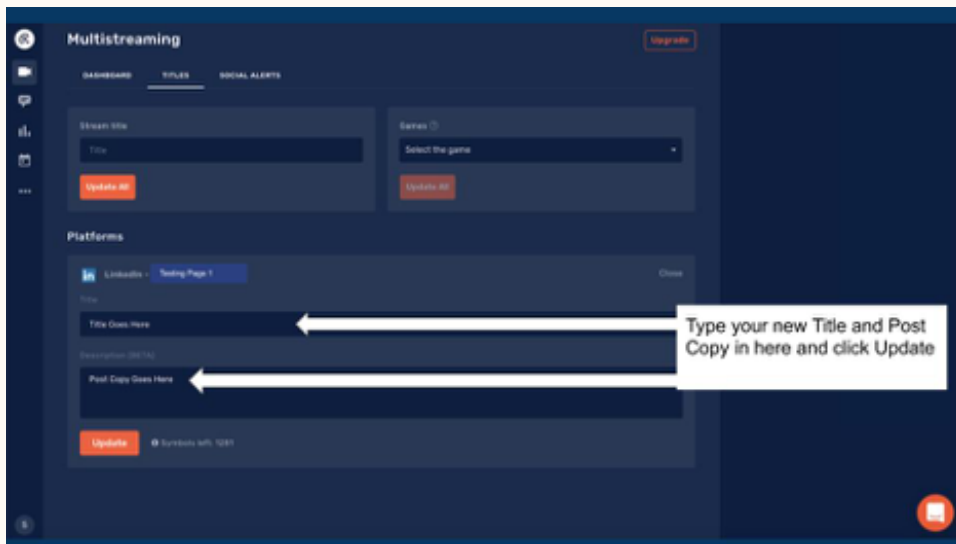

Step 4 — Grab the RTMP URL and Stream Key and input them into your encoder. Begin streaming to Restream to preview the audio and video in the preview window. Toggle the slider to the On position to begin streaming to LinkedIn Live.

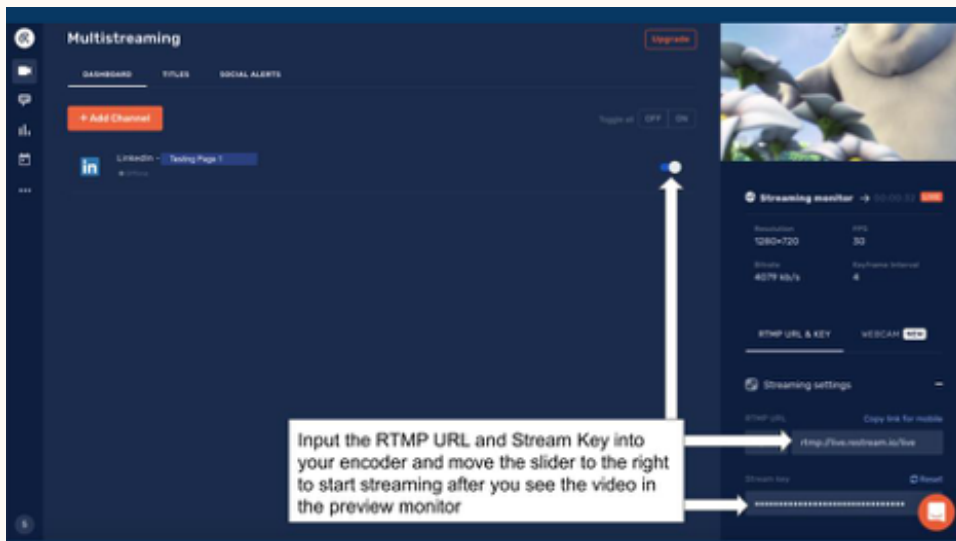

Wirecast

See our step-by-step guide below.

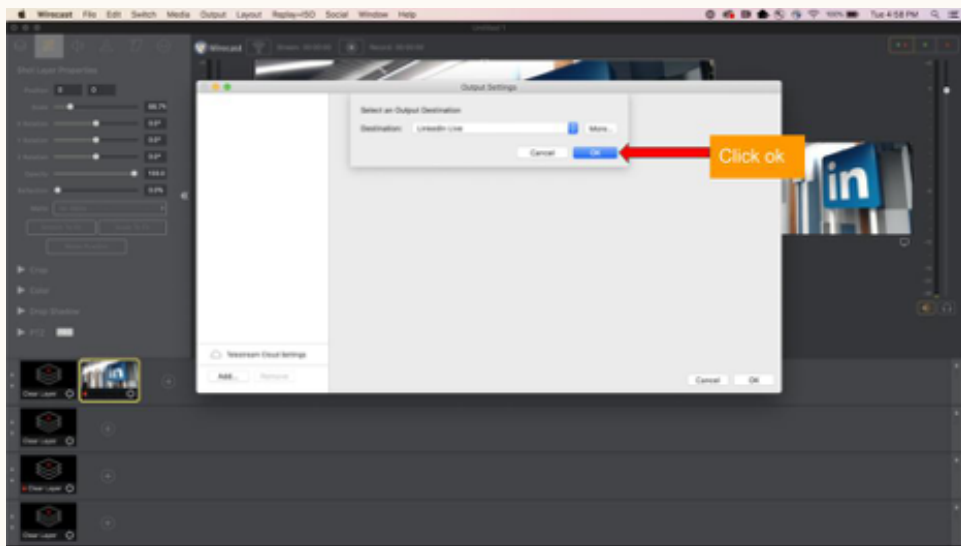
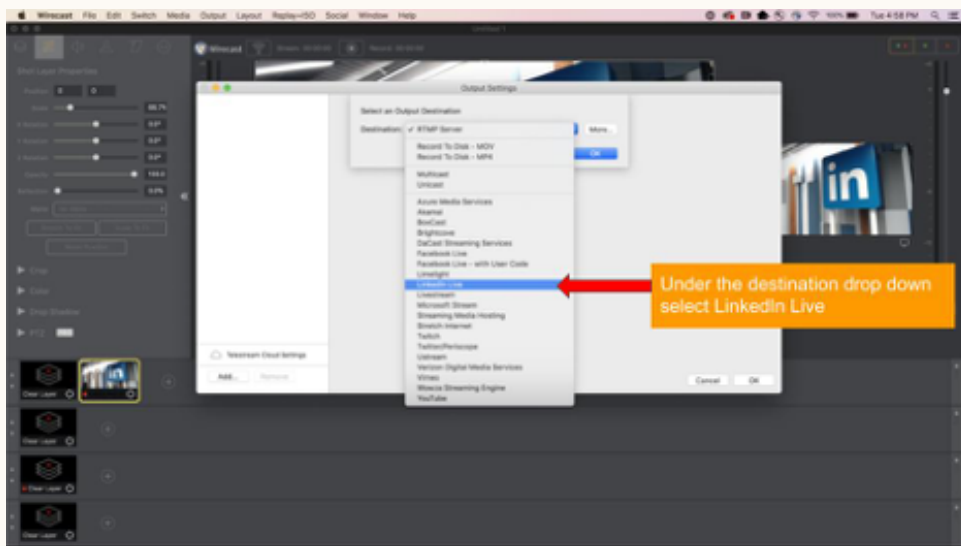
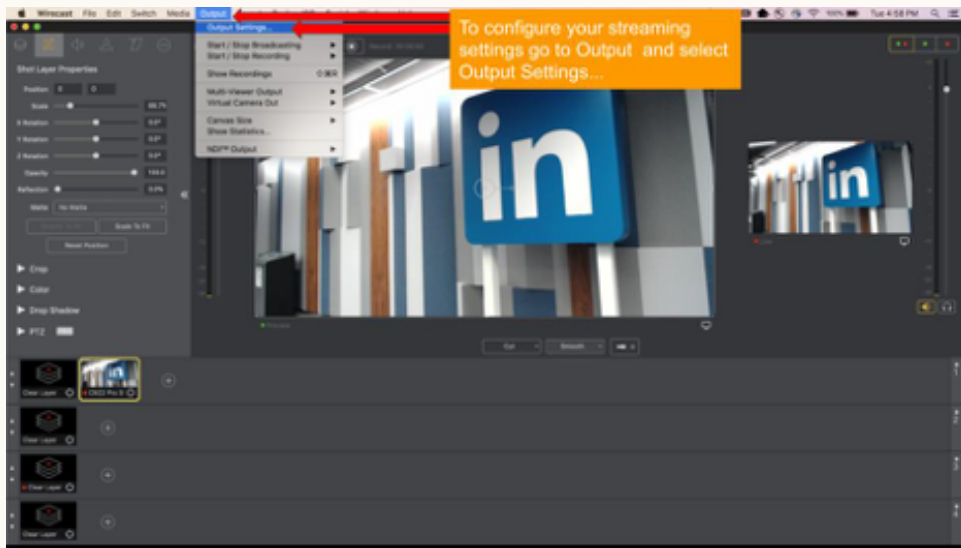

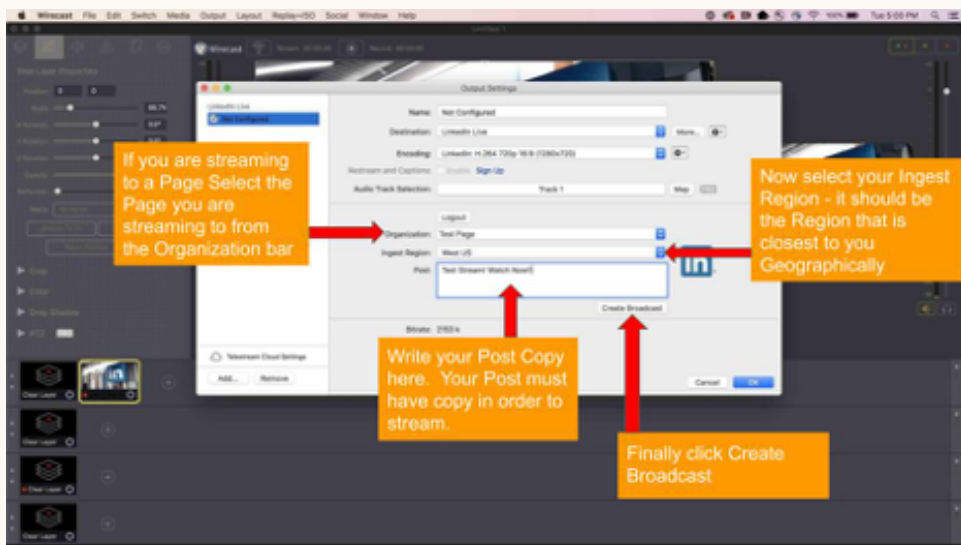
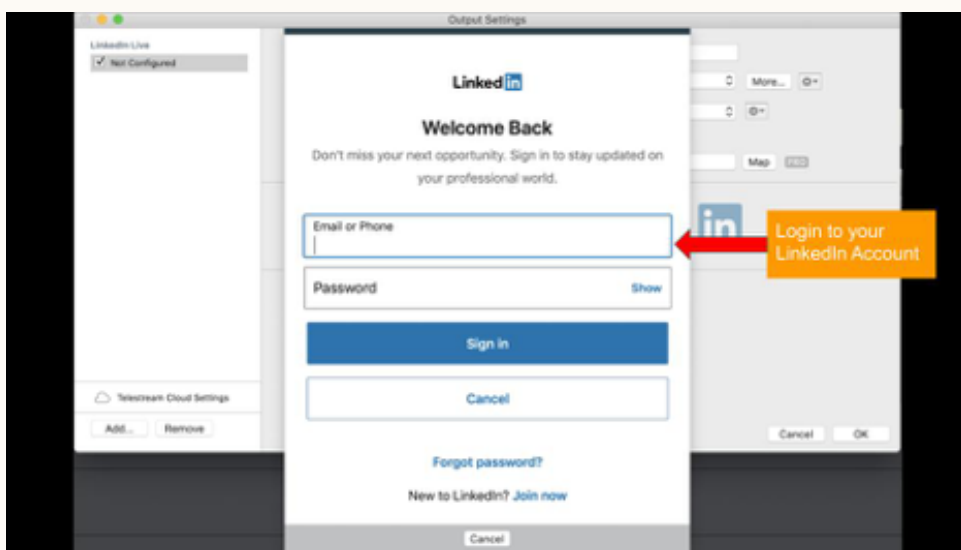
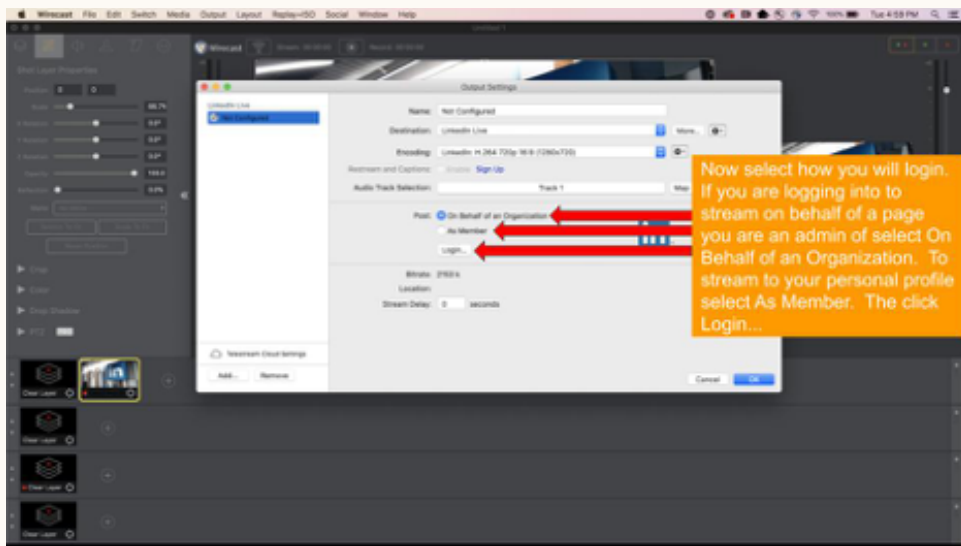

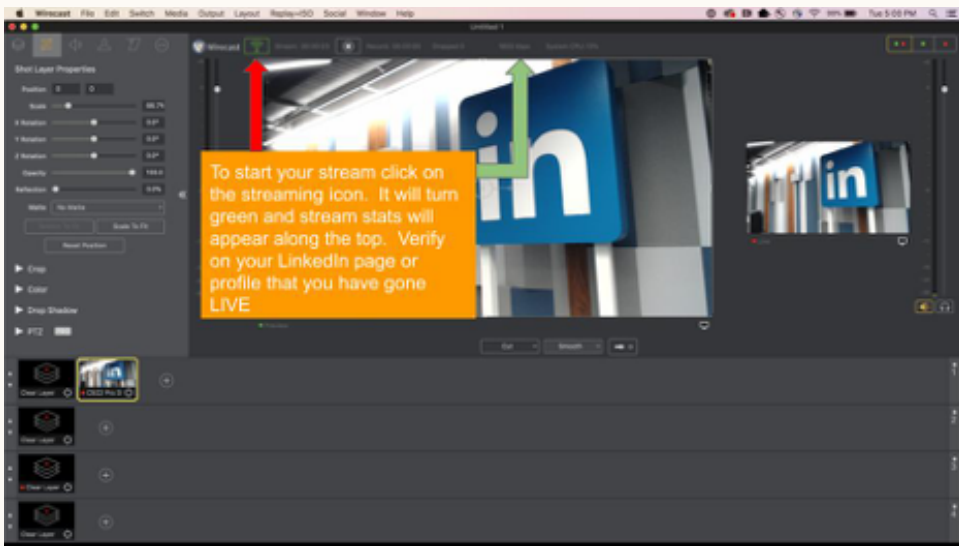
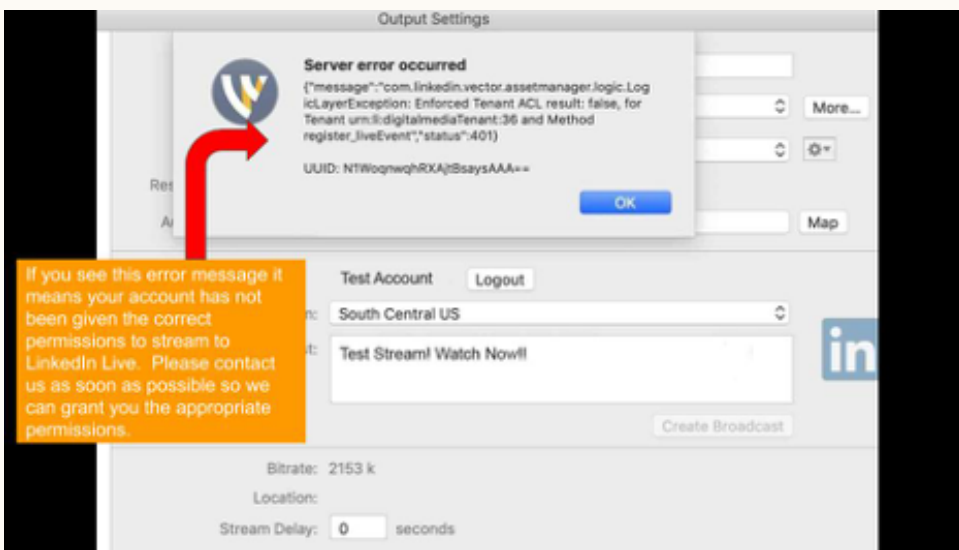
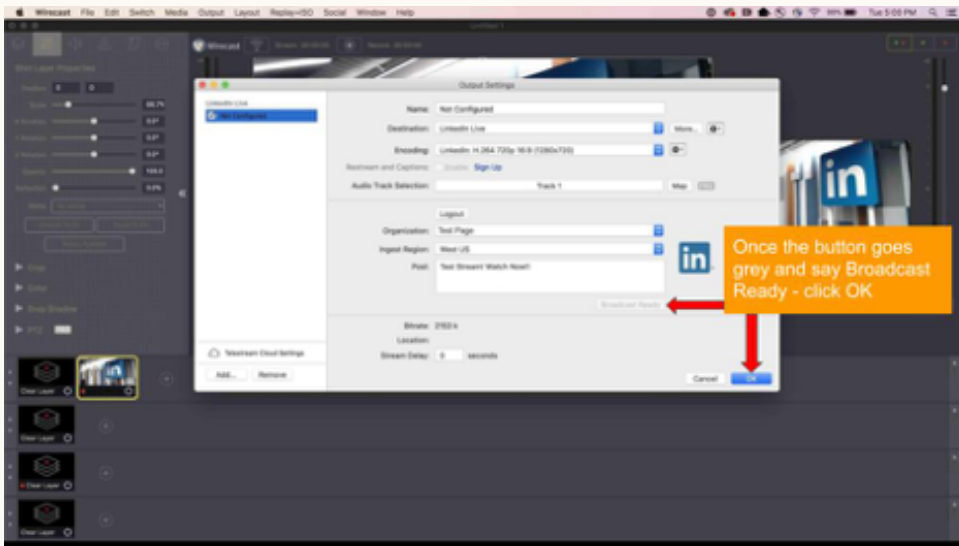

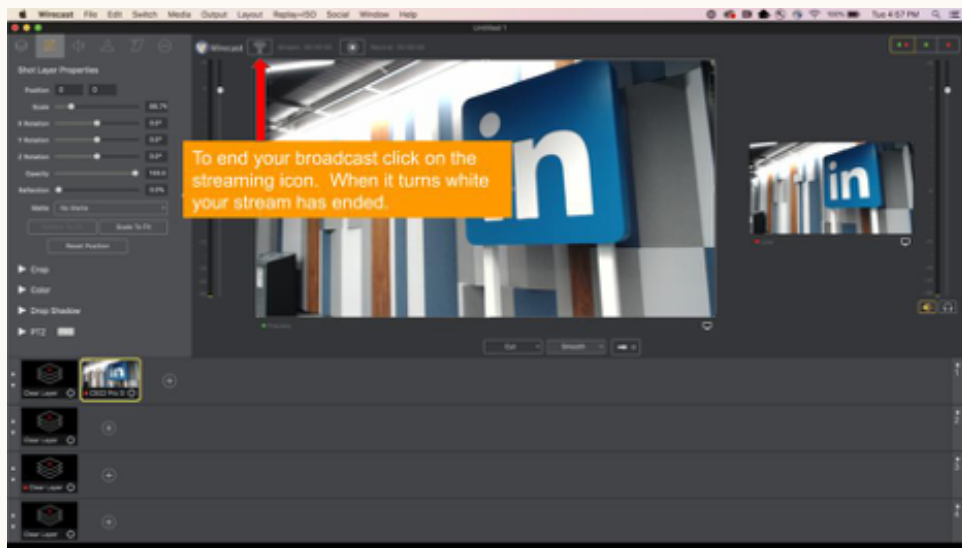

Teradek Core

See our step-by-step guide below.

Step 1 — Pair Teradek Cube with Core

Step 2 — Find Cube in Core and select

Step 3 — “Create Channel”

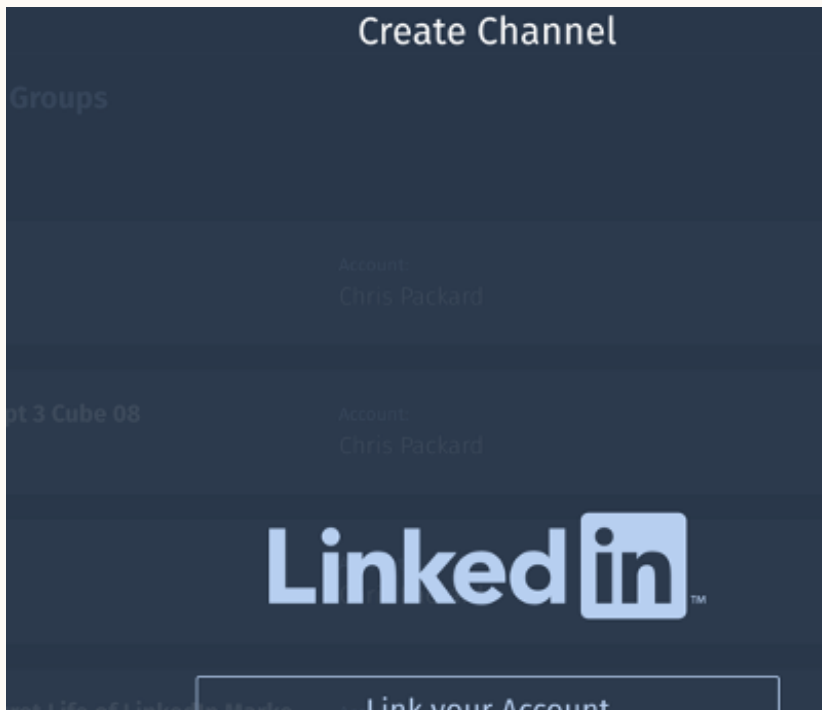
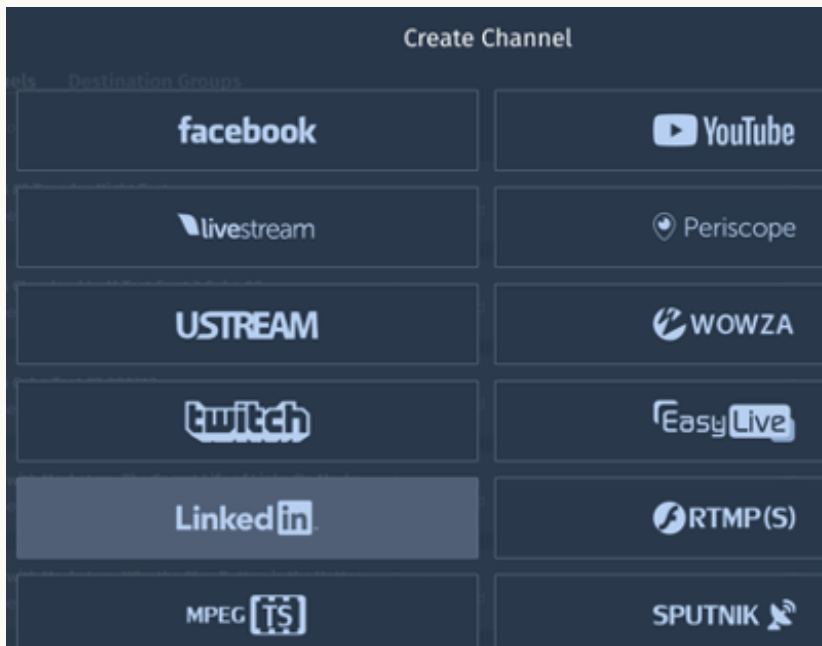

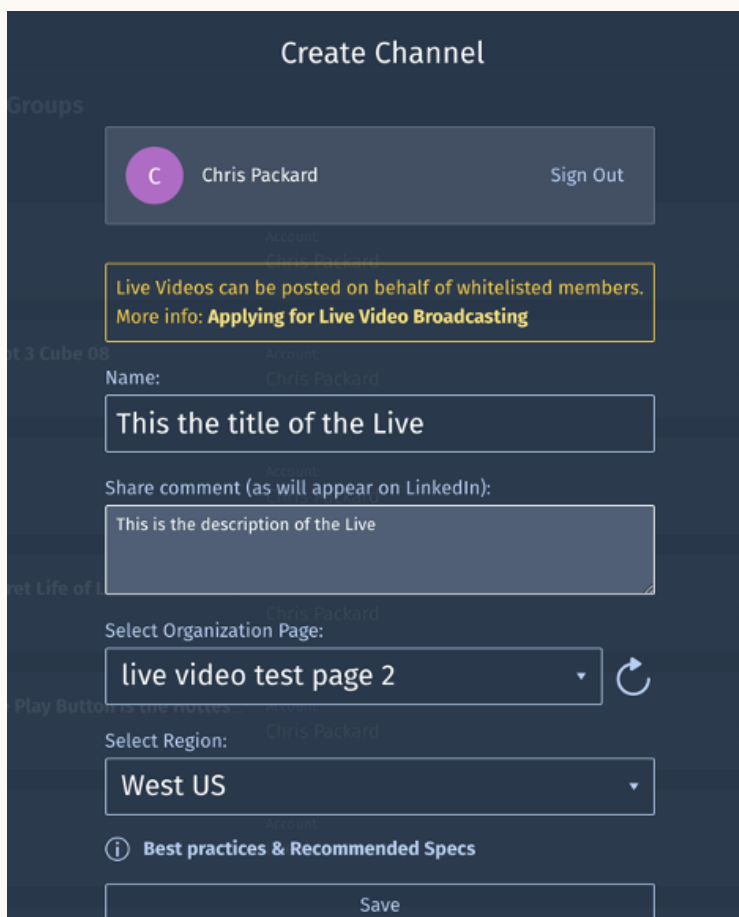
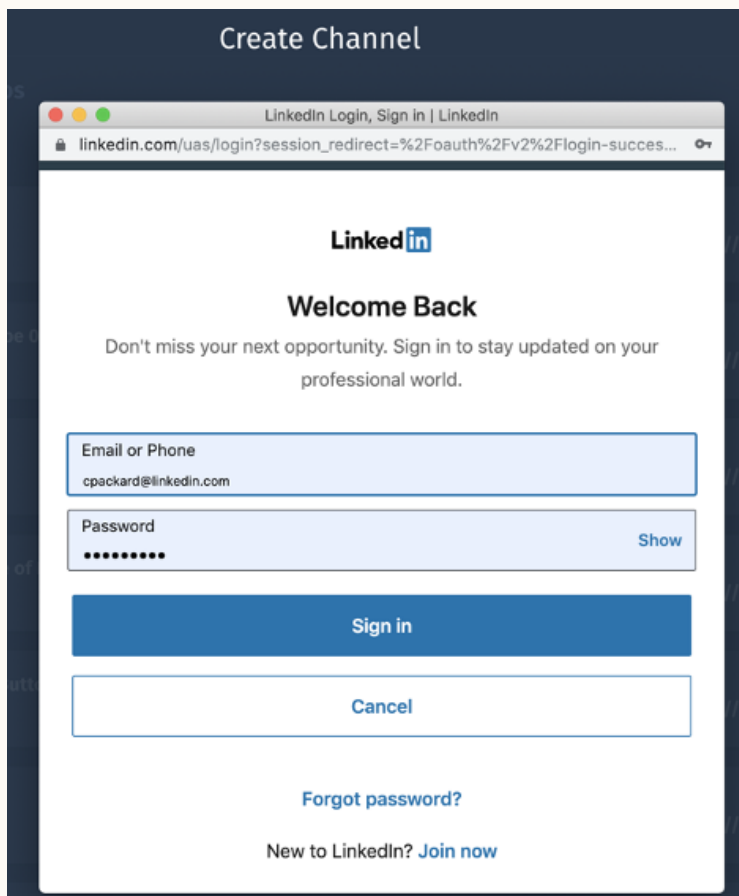

(Add go live steps from both pairing encoders to pushing live)

Live U Solo

See our step-by-step guide below.

Add Go Live steps when Live U is hooked up

LIVE U SOLO (with screenshots)

Step 1 — Pair with Live U

Step 2 — Select LinkedIn as a destination

Step 3 — Put in metadata for link

Step 4 — Send Live

Step 5 — To find the livestream, click “Active Broadcast”

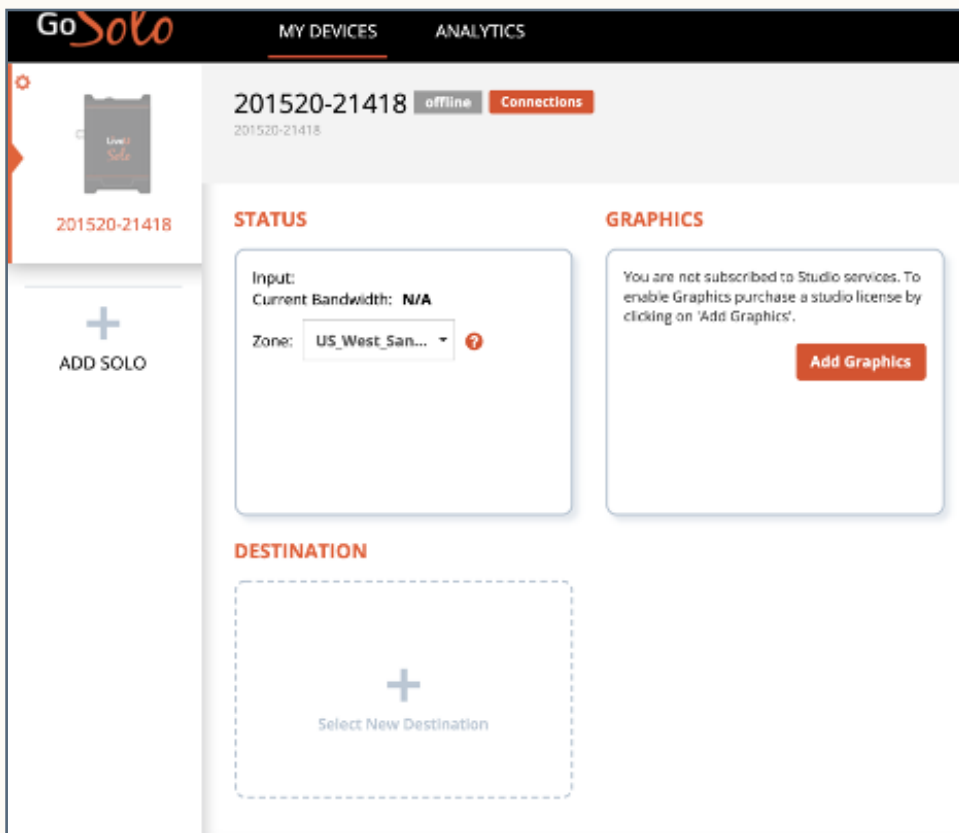

One-Touch Streaming



Facebook

[New Post](#)
[Sign in](#) to view Facebook destinations.



YouTube

[Add Events](#) [Stream Now](#)
[Sign in](#) to view YouTube destinations.
ⓘ The dashboard events are created directly from YouTube Dashboard. You can stream on the event by accessing the Edit option. The events having profile/binder 1440p or 2160p won't get listed above.



Boxcast

Easy Live

LinkedIn

Mixer

Periscope and Twitter

Restream.io

GoSolo LiveU

MY DEVICES ANALYTICS

LinkedIn Destination - Page

[Stream on Profile](#) [Back](#)

Destination Name

Profile

Stream on

Region

PROFILE SETTINGS (ADVANCED) ▼

[Submit](#)

[Sign in with a different account](#)

Wowza Cloud

See our step-by-step guide below.

Step 1 — Create Transcoder

Step 2 — Create Target

Step 3 — Start Transcoder — Target will go live automatically

Add Transcoder: Transcoder Setup

* = Required field

Hide Help >

What is the name of your transcoder?*

Test Transcoder

Broadcast Location*

US West (California)

Do you want to record this transcoder?

☐ Yes, record this transcoder

Closed Captions

CEA-608 (digital)

Source Protocol*

☒ RTMP

☐ RTSP

☐ SRT

What is the source delivery method?*

☐ Pull from a source URL

☐ Push to an existing stream source

☒ Push to Wowza Streaming Cloud

Source Stream Extension

.extension

If your video source appends an extension to the outbound stream name, enter it here.

What buffer size do you want to use?*

4 seconds

More Options

☐ Turn off sort packet buffer?

☐ Use stream smoother?

Use stream smoothing for improved playback over very slow networks

☐ Disable stream targets on transcoder start?

Select to leave all stream targets disabled when you start the transcoder

Shut down the transcoder after it's been idle for:

1200 seconds

Enter the timeout in seconds (for example, 1200 seconds = 20 minutes, 0 seconds = disabled)

Source Security

☒ Disable authentication?

Select to disable authentication on the video source

Watermark

☐ Embed a watermark in the transcoded stream?

Description

Provide details for your own reference

Cancel + Add

Test Transcoder

Status: stopped - Created on 05 September 2019 03:54 PM PDT by Dan Swiney

[Overview](#) [Health](#) [Transcoder Setup](#) [Properties](#) [Outputs & Targets](#)

[Hide Help >](#)

 You must add at least one output to this transcoder before you can start it.

[+ Add Output](#)

Test Transcoder

Status: stopped - Created on 05 September 2019 03:54 PM PDT by Dan Swiney

[Overview](#) [Health](#) [Transcoder Setup](#) [Properties](#) [Outputs & Targets](#)

[Hide Help >](#)

Add an Output

Stream Format*

Video+Audio

☒ Passthrough Video*

☒ Passthrough Audio*

Video Bitrate (Kbps)*

0

Audio Bitrate (Kbps)*

0

H.264 Profile*

Main (best for Flash)

Frame Rate Reduction*

0 (no reduction)

Aspect Ratio: 16:9 (Widescreen)

1920 x 1080

Keyframe Interval*

Follow Source

The number of frames between keyframes in the source video

[Save](#) [Cancel](#)

Test Transcoder

Status: stopped - Created on 05 September 2019 03:54 PM PDT by Dan Swiney

[▶ Start Transcoder](#)

[Overview](#) [Health](#) [Transcoder Setup](#) [Properties](#) [Outputs & Targets](#)

[+ Add Output](#)

[Hide Help >](#)

mlyjtb4r - Video+Audio=Passthrough+Passthrough

[Edit](#) [Copy](#) [Delete](#)

 There are no stream targets assigned to this output.

[+ Add a Stream Target](#)

Wowza CDN - HDS/HLS
Wowza CDN - HLS
Custom
Facebook Live
LinkedIn Live
Existing stream target

Test Transcoder

Status: stopped - Created on 05 September 2019 03:54 PM PDT by Dan Swiney

Stream to LinkedIn as a:

☐ Person

☒ Organization

Next

Hide Help >

LinkedIn

Welcome Back

Don't miss your next opportunity. Sign in to stay updated on your professional world.

Email or Phone

Password

Show

Cancel

Sign in

Forgot password?

New to LinkedIn? [Join now](#)

Test Transcoder

Status: stopped - Created on 05 September 2019 03:54 PM PDT by Dan Swiney

Add a LinkedIn Live target

Hide Help >

Target Name*

LinkedIn Live

Stream to

live video test page 1

Title

Copy for Test Stream

Description

Region*

West US

Cancel

Save

Test Transcoder

Status: stopped - Created on 05 September 2019 03:54 PM PDT by Dan Swiney

Start Transcoder

Overview

Health

Transcoder Setup

Properties

Outputs & Targets

+ Add Output

Hide Help >

mlyjtb4r - Video+Audio+Passthrough+Passthrough

Stream Target

Target Type

Stream Name

Actions

LinkedIn Live

LinkedIn Live

Actions

Add a Stream Target

Test Transcoder

Status: stopped - Created on 05 September 2019 03:54 PM PDT by Dan Swiney

▶ Start Transcoder

Overview Health Transcoder Setup Properties Outputs & Targets

Edit Hide Help >

Transcoder Name	Test Transcoder
Billing Mode	Pay as you go
Broadcast Location	US West (California)
Recording	No
Closed Captions	CEA-608 (digital)
Source Delivery Method	Push to Wowza Streaming Cloud
Source Protocol	RTMP
Host Server	9176a8.entrypoint.cloud.wowza.com
Host Port	1935
Application Name	app-7bd5
Stream Name	60c4370a
Buffer Size	4 seconds
Sort Packet Buffer Disabled	No
Stream Smoother	No

Test Transcoder

Status: stopped - Last stopped on 05 September 2019 04:03 PM PDT by Dan Swiney

▶ Start Transcoder

Overview Health Transcoder Setup Properties Outputs & Targets

Hide Help >

Video Thumbnail

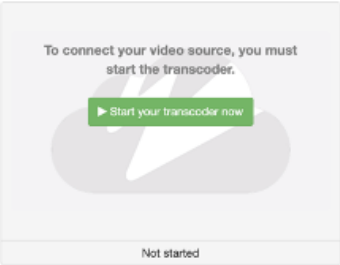

Statistics

Inbound: Connected	--
Inbound Bitrate: Actual	--
Outbound Bitrate: Actual	--
Outbound Bitrate: Configured	0.0 Kbps
CPU Usage	--
Frame Size	x
Frame Rate	--
Keyframe Interval	--
Total Unique Viewers	--

Broadcast Location

US West (California)

Source Protocol

RTMP

Outputs & Targets

Output Video+Audio=Passthrough+Passthrough
Target(s) LinkedIn Live

Test Transcoder

Status: started - Started on 05 September 2019 03:58 PM PDT by Dan Swiney

■ Stop Transcoder

↺ Reset Transcoder

- ✓ Overview
- ♥ Health
- ⚙ Transcoder Setup
- </> Properties
- ➡ Outputs & Targets

Hide Help >

Video Thumbnail

NO VIDEO
DETECTED

▶ Started 05 September 2019 03:58 PM PDT

Statistics

Inbound: Connected	🟡 No
Inbound Bitrate: Actual	0 bps
Outbound Bitrate: Actual	0 bps
Outbound Bitrate: Configured	0.0 Kbps
CPU Usage	7 %
Frame Size	x
Frame Rate	0 FPS
Keyframe Interval	0 GOP
Total Unique Viewers	0

Broadcast Location

US West (California)

Source Protocol

RTMP

Outputs & Targets

Output Video+Audio=Passthrough+Passthrough
Target(s) 🚩 [LinkedIn Live](#)

Easy Live

See our step-by-step guide below.

Step 1 — Use the calendar to select a date and time and click “create a new live-stream”

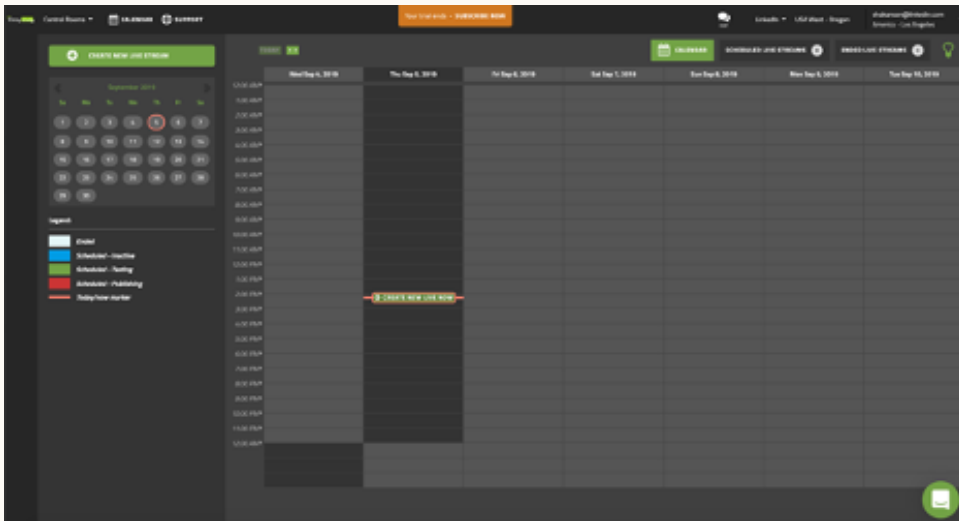

Step 2 — Title and schedule your live-stream from the screen below

Create new live stream

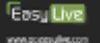

Import the image with as high a resolution as possible: it will be used as a preview for your event on other websites (recommended size: 1920 x 1080 pixels).

UPLOAD YOUR IMAGE

Title

#2 Test Title field Easy Live

Date

09/05/2019

Start Time

2:17 PM

Visibility

Public

Description

Test: Description Text Easy Live

Layout From

5119 - #2 Test Title field - August 15, 2019 2:57 PM

facebook advanced

CREATE AND GO TO CONTROL ROOM

Step 3 — Once you reach the control room view, select add or edit publishing points

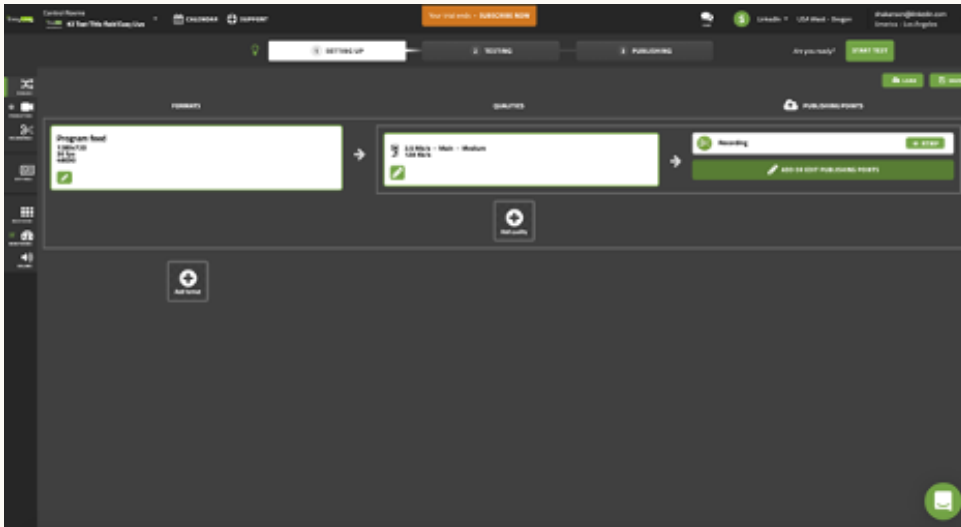

Step 4 — Log in to your LinkedIn account and select your page or profile

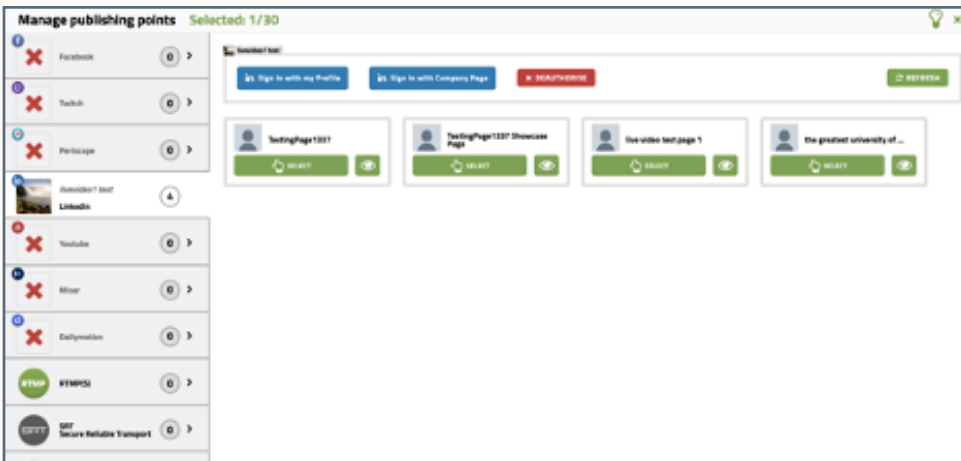

Step 5 — Add or change the post copy



Step 6 — Select the Production Icon to add and control video/audio production elements for your stream

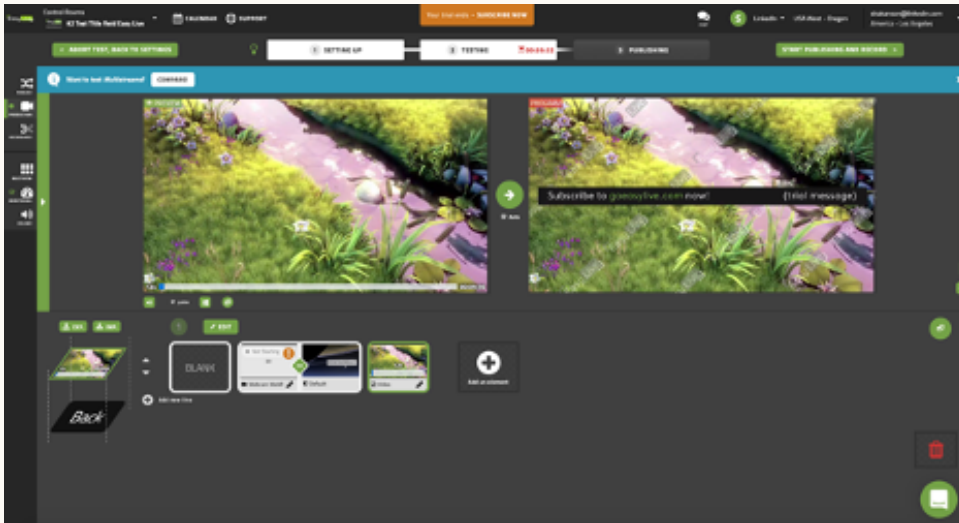

Step 7 — Return to the Publish Icon and click Start Test

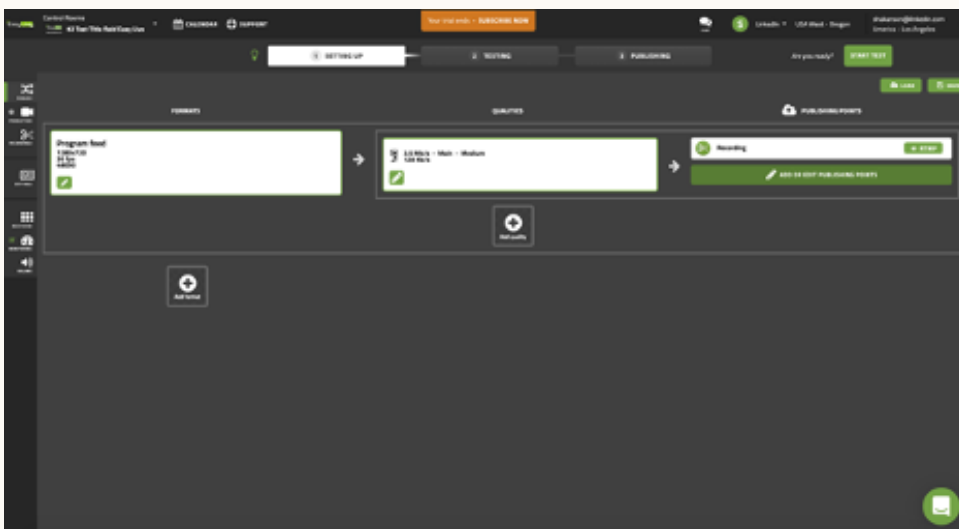

Step 8 — Finally, click Start Publishing and Record to start streaming to LinkedIn Live

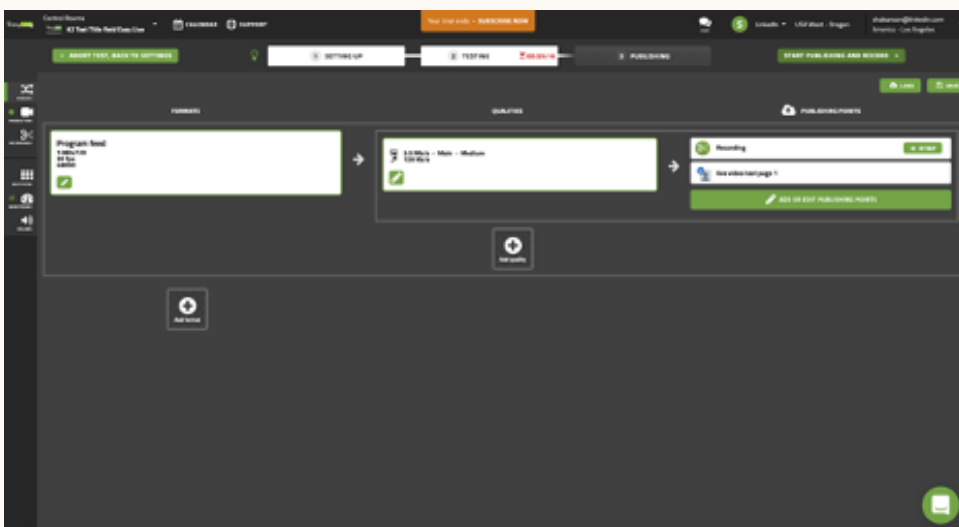

Vimeo Live

See our step-by-step guide below.



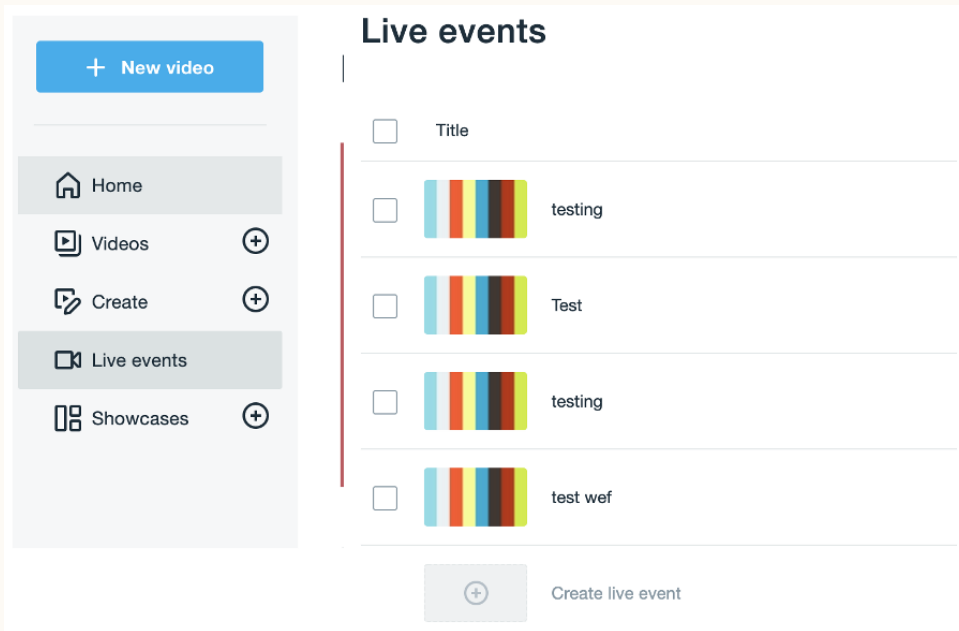

Step 1 — Create live event in Vimeo

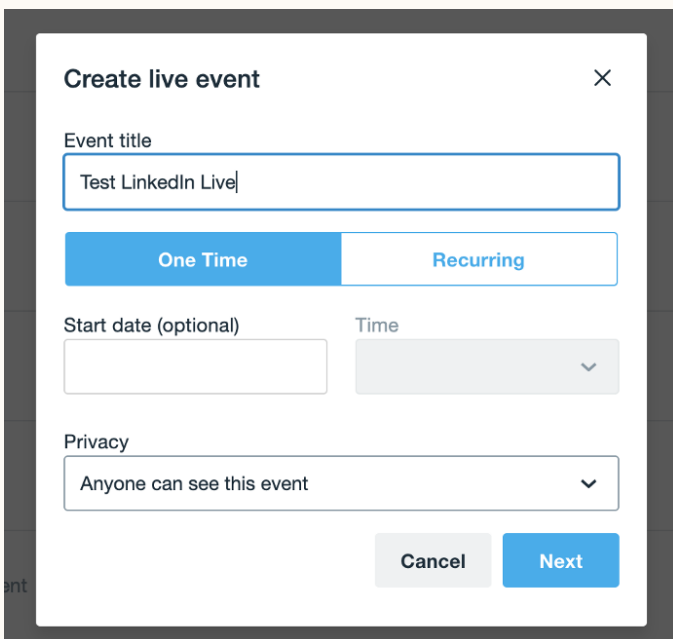

Step 2 — Enter a live event title (note: this is the Vimeo event and not the LinkedIn Live event title). Then select Next.

A screenshot of the 'Create live event' dialog box. The title 'Create live event' is at the top left, and a close button 'X' is at the top right. The 'Event title' field contains the text 'Test LinkedIn Live'. Below this are two buttons: 'One Time' (highlighted in blue) and 'Recurring'. Underneath are two fields: 'Start date (optional)' and 'Time' (a dropdown menu). Below these is a 'Privacy' dropdown menu set to 'Anyone can see this event'. At the bottom are two buttons: 'Cancel' and 'Next' (highlighted in blue).

Step 3 — Enter the title/description for the LinkedIn Live Event

Onsite	Embed	Destinations
<p>Link</p> <div><input type="text" value="https://vimeo.com/399038577"/></div> <p><input checked="" type="checkbox"/> Chat ⓘ</p> <p>Who can watch this event?</p> <div>Anyone</div> <p>Where can this event be embedded?</p> <div>Anywhere</div> <p>Description (optional)</p> <div><p>This is the description on the LinkedIn Live Post </p></div>		

Step 4 — Select “Next” to get RTMP Ingest URL

[Events](#) > [Test LinkedIn Live](#)

[Onsite](#) | [Embed](#) | [Destinations](#)

Link

<https://vimeo.com/399014315>

☐ Chat

Who can watch this event?

Anyone ▼

Where can this event be embedded?

Anywhere ▼

Description (optional)

Enter description (only appears on vimeo.com)

Test LinkedIn Live
 from Chris Packard

This event hasn't started yet

o LIVE...ml :: vimeo

[Choose thumbnail](#)
[Schedule your event](#)

Step 5 — Select Connect RTMP Tab, then pull RTMP URL and Stream Key for Encoder

Webcam

Connect (RTMP)



Stream with Studio

Go live the premium way. Download Studio, our live production switcher software — free with your membership.

[↓ Get it free](#)

Connect to your encoding software

Paste the URL and stream key into your software's settings and begin streaming.

RTMP URL

rtmp://rtmp-global.cloud.vimeo.com/live

Stream key

ef28cde2-eac8-4e40-b2a1-37b5c8124658

+ Add backup stream [UPGRADE](#)

☐ Preview stream before going live ⓘ

Step 6 — Make sure Company Page toggle is set to “off”

Destinations

 Vimeo

Share

View

 Facebook

Connect

 YouTube

Connect

☐  Live Video Test Page 3
Company page

...

 RTMP

Add

Step 7 — Send Stream from your encoder. The “Go Live” button will change to live with “End event” showing. Ensure you have a “good connection.”

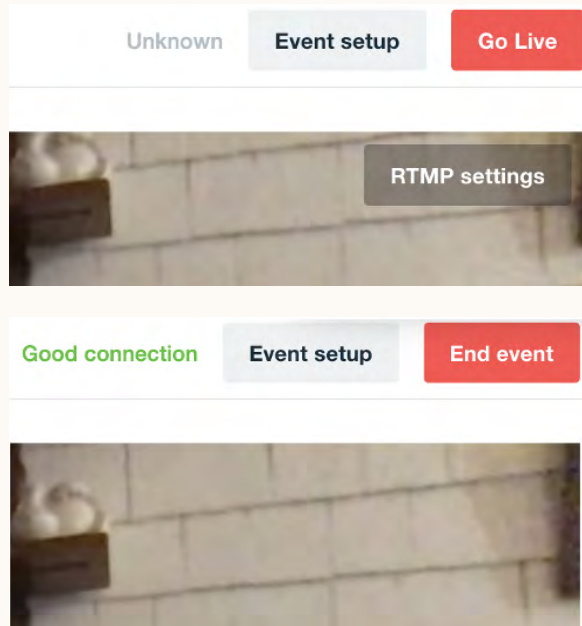

Step 8 — Toggle Company Page “on” to go live to LinkedIn. You will see the wheel spinning when you are live to LinkedIn.

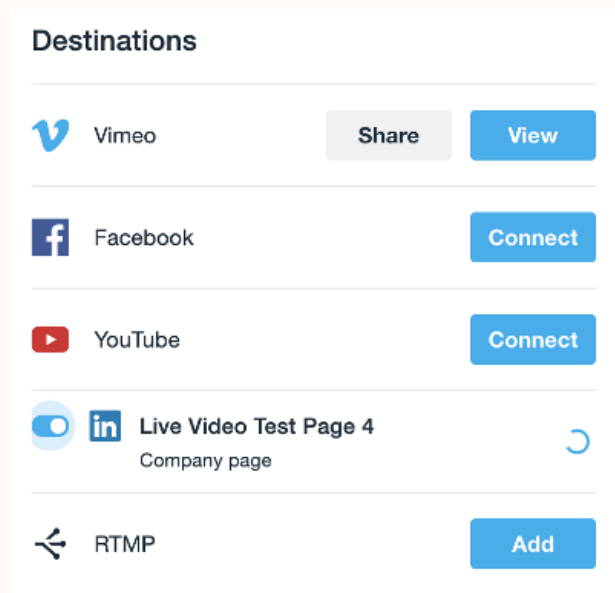

Thank you!

Visit the LinkedIn Live Resource Hub for more information

[Get started](#)

LinkedIn Marketing Solutions